



INSTRUCTIONS

Thank you for shopping at Car Builders.

In the table below, you can see where we have allocated individual products in the Canter Pack.

For further questions or concerns, please contact us 03 8777 0960

**Please ensure you follow the allocation table for the pack you purchased*

Canter Pre-Cut Complete Pack

Product	Floor Pan	Rear Fire wall	Doors	Roof & Walls
Sound Deadener	2 boxes	1box	1 box	2 boxes
Mass Noise Liner	Precut Sheets			
Insul-Layer				Precut Sheets

Tips

Stage 1 - Sound Deadener (SD)

- Map out the allocated SD to visualise coverage. Lay the sheet on the surface to assess if/how it needs to be cut to fit in planned area.
- Ensure the surface is clean using a white-based spirit (avoid turpentine).
- Reveal the backing of the SD. Place an end on the surface and slowly lay it down in a rolling motion until the sheet is laying on the surface. Do not pull the deadener over any depression in the surface, rather feed it down into the valley.
- Use your application roller to apply moderate pressure evenly across the total surface. Use the handle of the roller to apply pressure in valley areas.

Coverage - Stage 1 Sound Deadener does not need to cover 100% of the surface. Before applying SD please map out the material to ensure that you have an even spread across the allocated area. You may find that you have excess sheets in your pack, these can be used in areas where you feel more is required.

Sheets can abut or slightly overlap. There may be sections with gaps between sheets. There is no need to apply to mounts, top hats, cross members etc (you are aiming to cover single sheet metal panels). Ensure you leave clearance for bolt down points and areas that require future access.

Stage 2 - Mass Noise Liner (MNI)

- This product is not a peel and stick product.
- It will sit under its own weight on the floor pan.
- Lay the product down foam side down, vinyl side up as per the templates on pages 4-5 of this instruction sheet. Spray Adhesive to be used on vertical sections.

Stage 2 - Insul-Layer (INL)

- This is a peel and stick product.
- Once you have the template, reveal one end of the product and line it up on the surface. Then slowly reveal the backing while rolling the material onto the surface, ensuring you aren't stretching the product, rather try to slightly compress the material. This is particularly important when rolling the material into depressions in the sheet metal. If you stretch the material over and then try to push it into a depression, the material will fight to pop back up.
- Use the application roller to apply a moderate pressure evenly across the total surface. If you happen to get an air pocket under the material, you can prick through the material to release the air and use the roller to press it down.

Peel and Stick Heat Shield (PEELSHIELD)

- This is a peel and stick product.
- Reveal one end of the product and line it up on the surface. Then slowly reveal the backing while rolling the material onto the surface.
- Use the application roller to apply a moderate pressure evenly across the total surface.
- It's recommended to use Car Builders Heat Proof Foil Tape to seal edges.

For further questions or concerns, please contact us on 03 8777 0960.

We would love to see your project and photos/video of your Car Builders pack installed. Tag us in your social media so that we can give you a shout out on our social platforms.





CANTER MASS NOISE LINER FLOOR

Stage 2 Mass Noise Liner is applied after Sound Deadener, foam side down. Some areas may require spray adhesive to hold in place for best fitment.

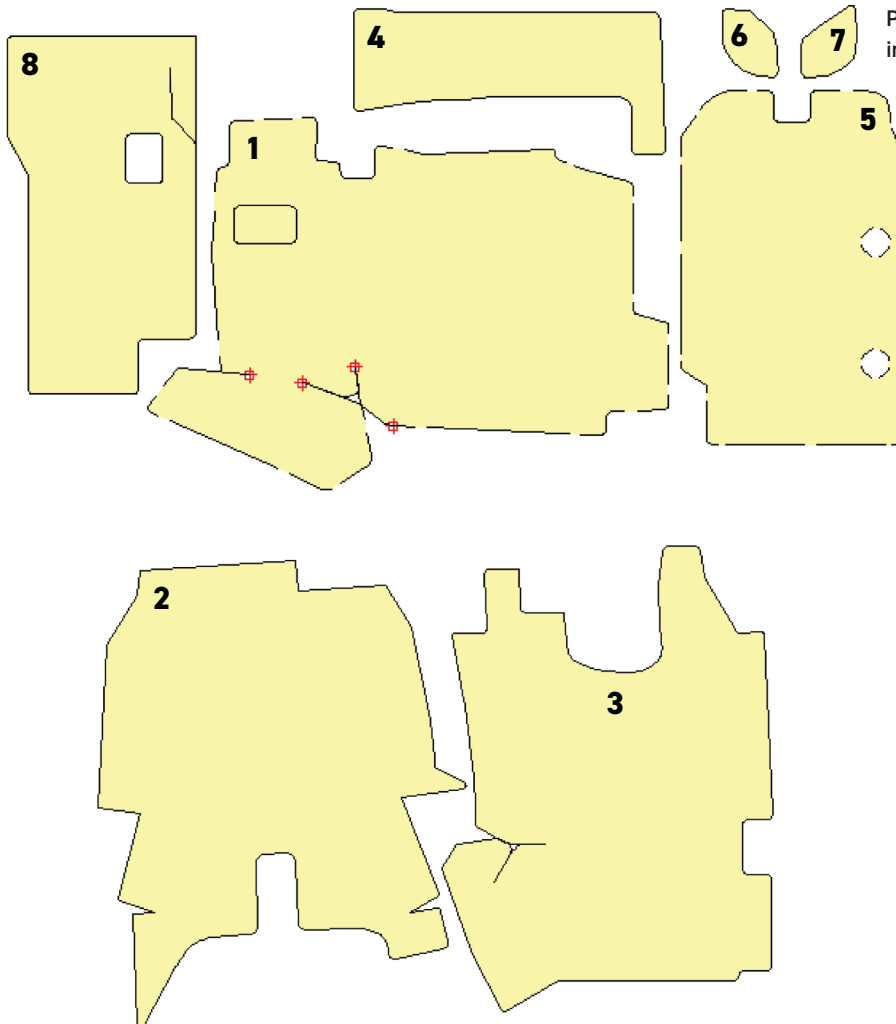

Pieces 6 & 7 are applied in wells under piece 5.



CANTER MASS NOISE LINER FLOOR

Stage 2 Mass Noise Liner is applied after Sound Deadener, foam side down. Some areas may require spray adhesive to hold in place for best fitment.

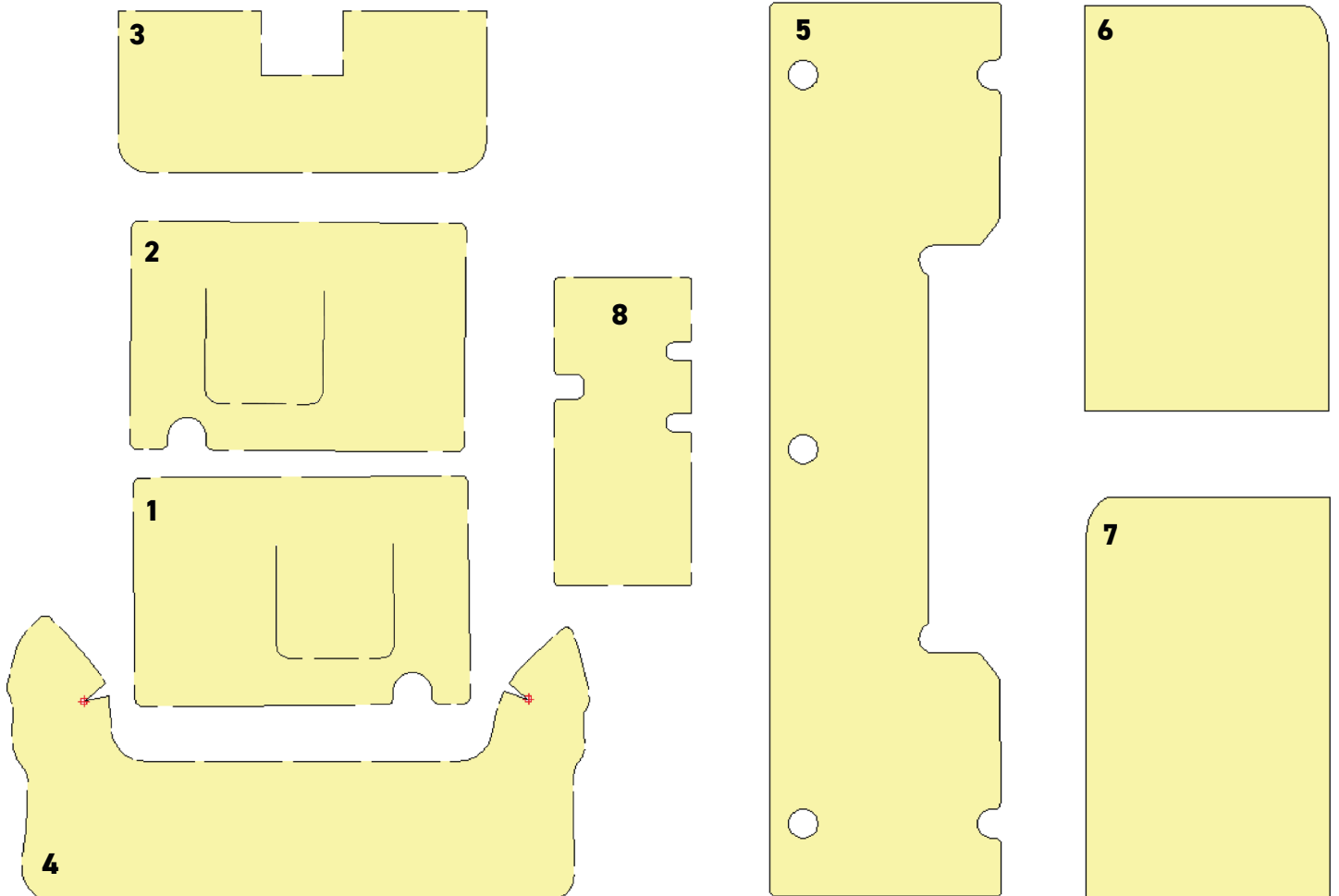
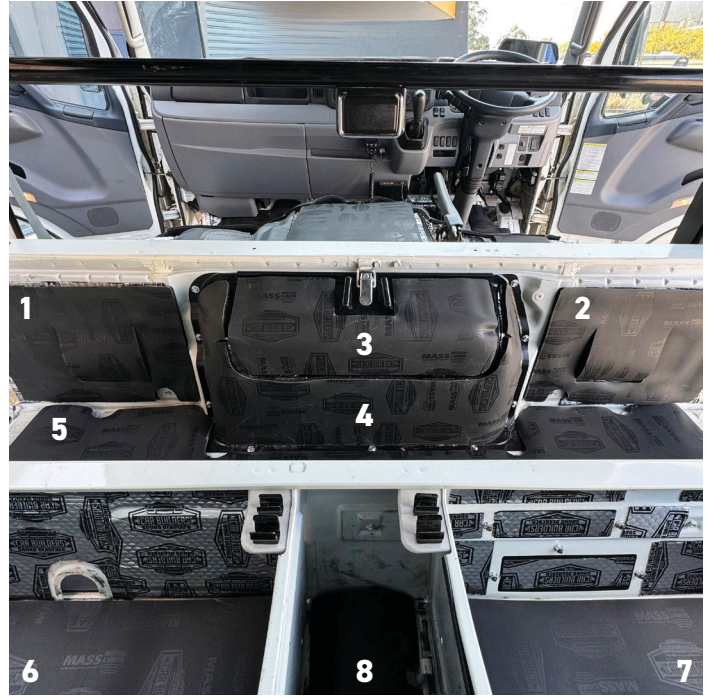



CANTER REAR WALL

Stage 1 Sound Deadener

CANTER WALL PANELS

Stage 1 Sound Deadener

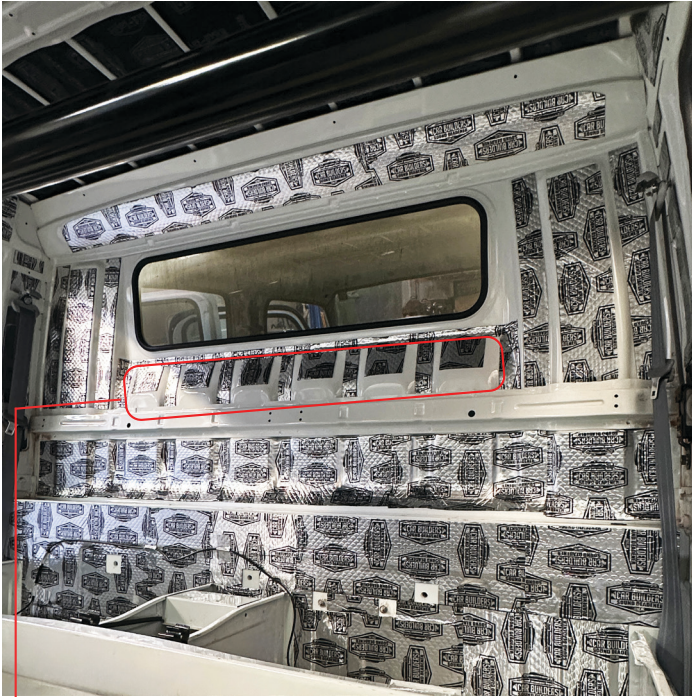

Do not place Sound Deadener in this area, as it will prevent the plastic trim from fitting properly.

The seats will cover the deadener applied to the lower section of the rear wall.



This kit includes sufficient sound deadener to cover the wall panels.

Apply Sound Deadener in this area to ensure plastic trim will fit properly.

CANTER ENGINE COVER

Stage 1 Sound Deadener and Peel and Stick Heat Shield



SOUND DEADENER

Stage 1 Sound Deadener is applied directly to the bottom of engine cover. Use Car Builders' Decent Pair of Scissors.

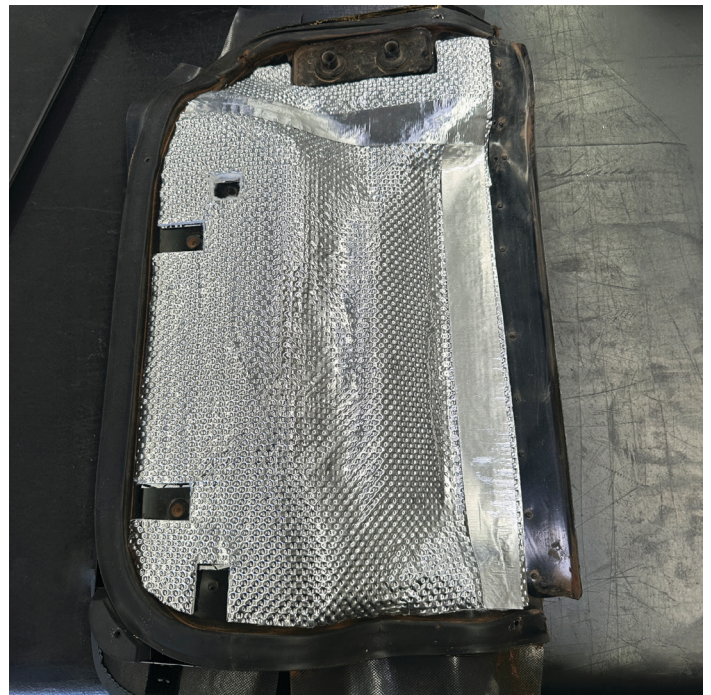

PEEL & STICK HEAT SHIELD

Peel & Stick Heat Shield is applied after the Sound Deadener. The thermal barrier is applied to block engine heat.